

LED 125

The latest advancement in portable exam “HeadLite” technology.

Burton’s LED 125 HeadLite is a durable, affordable alternative to similar filament bulb (Xenon, Halogen etc.) headlamps. Shock and vibration resistant, LEDs have no glass or filaments to break – making them much more durable than other light sources. Add the combination of a long LED life (approximately 50,000 hours of use) and small power needs (the LED 125 HeadLite will run continuously on a single set of batteries for over 100 hours) which translates into lower operation, maintenance and upkeep costs for your practice. Also, the LED 125 HeadLite’s teal colored light and precise beam is easier on the eyes than other headlamps.



PERFORMANCE RELIABILITY VALUE



The durable, affordable alternative to Xenon and Halogen headlamps.

The Right Light

TASK & EXAMINATION

LED 125

Burton's affordable, reliable 1.25 watt LED exam headlight is almost maintenance-free.

LED 125 HEADLITE FEATURES:

- > Crystal reflector tubes for extra brightness; approximately 743 footcandles (8,000 Lux)
- > Powder coated metal casing protection
- > Nearly unbreakable Light Emitting Diode (LED)
- > Estimated 50,000 hour LED lifespan
- > Water resistant / shock proof
- > Weighs only 4.7 ounces
- > Includes a set of three 'AAA' batteries providing 100+ hours of life
- > Prism reflector system for optimal focus
- > 1-year warranty

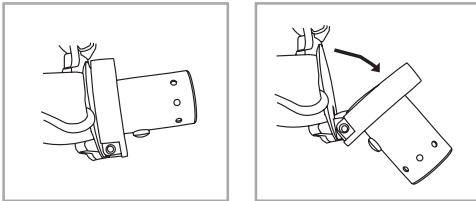

85° hinged adjustable beam includes 10 positions for precise illumination

MODELS

LED 125 LED 125 HeadLite 1.25 Watt

Three AAA batteries deliver 100+ hours of operation

Secure, soft, no sweat, adjustable headband



1.25 watt LED



Lighting Specialties
www.lightingspecialties.com
(800) 876-2852