

NEW COOL LED MACHINE ILLUMINATION

Our **NEW** Standard Intensity

Uniflex® **LED**



O.C. White Co.
Quality Since 1894

Waterproof Machine Light!

For any machine illumination application that demands the highest spot-light intensity as well as near limitless positioning possibilities while operating in the most challenging environments.

Our new **10300/11300 LED Series** is designed to provide years of reliable service and we back them with our 3-year warranty.

Fully sealed against the impingement of water, synthetic, and petroleum based fluids, the new 10300/11300 LED Series meets the stringent IP65 waterproof standards. Due to the rugged design, these fixtures are suitable for applications where extreme vibration shall be encountered. Our LED's provide 50,000+ hours of trouble free service.

Specifications

- 120V-277V AC, 50/60HZ (24V Available)
- 6 ft., 3 Prong Molded Cord
- Two Arm Styles Available
- Energy Efficient 4.5W LED
- Light Output: 270 total lumens.
- "No Heat" Spot Light
- Built-In Electronic Transformer
- Approvals: CE, IP65
- Mounting Options:
 - 300-MB (Magnetic Base Mount)
 - 300-WM (Wall Mount)
 - 300-CD (Table Edge Clamp)



LWL-10300-120



LWL-11300-120



300-MB
Magnetic Base Mount

WATER PROOF
IP65
UNDER PRESSURE



300-WM
Wall Mount

NEW COOL LED MACHINE ILLUMINATION

Technical Specifications



O.C. White Co.
Quality Since 1894

WATER PROOF
IP65
UNDER PRESSURE

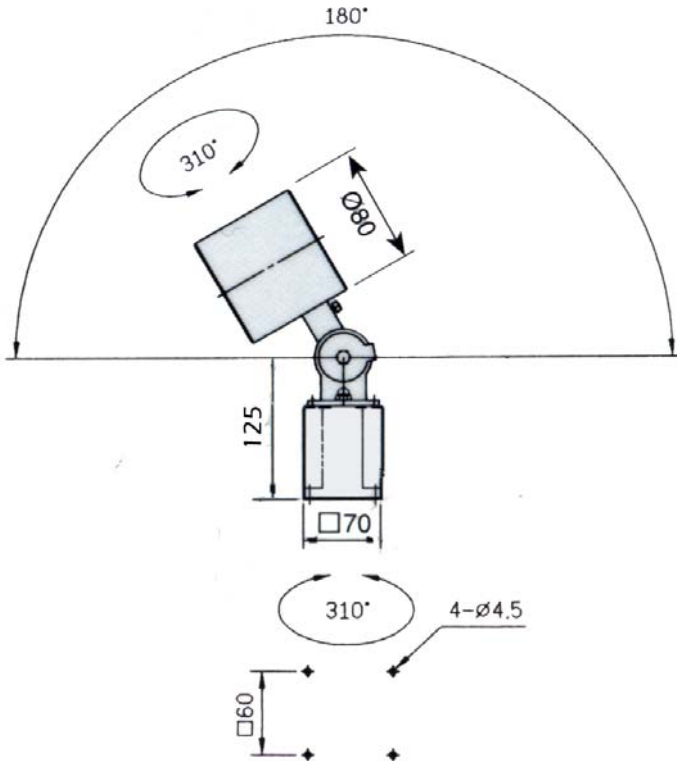

LWL-10300-120

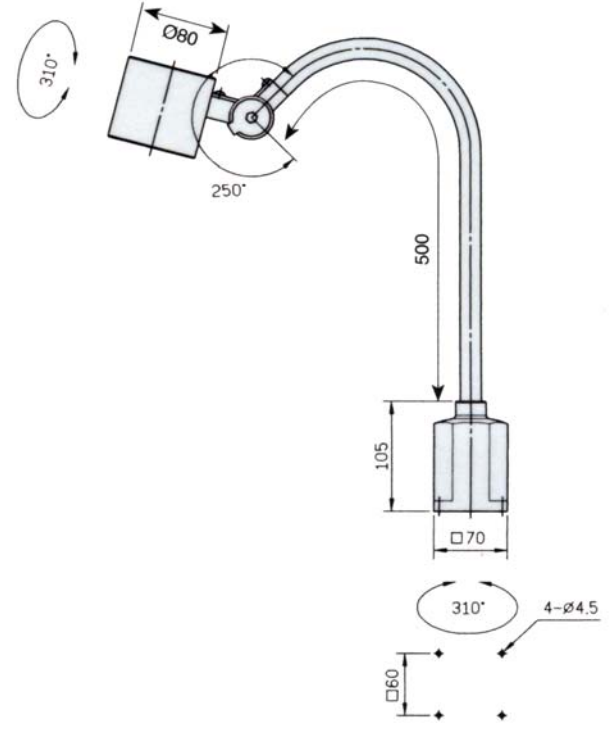

LWL-11300-120

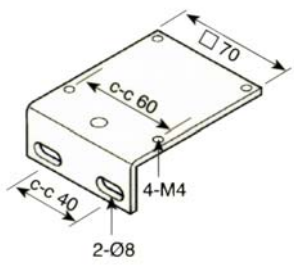

300-WM
Wall Mount

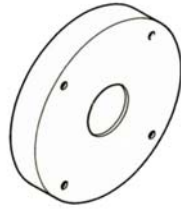

300-MB
Magnetic Base Mount

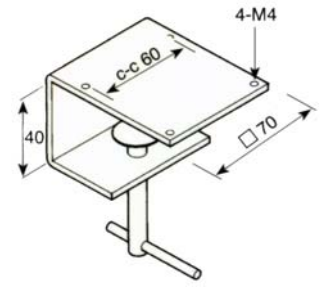

300-CD
Table Edge Clamp